

SB 18 SUBWOOFER



- Compact 18" subwoofer
- High power handling
- Designed for Kara and Kara II
- Simple, fast, integral rigging



ELECTRO-ACOUSTICS



SB18 is a compact subwoofer designed to extend the bandwidth of the Kara and Kara II systems in mobile and touring applications. SB18 features one high-excursion, direct-radiating 18" transducer mounted in a dual bass-reflex tuned enclosure.

SB18 can be coupled mechanically and acoustically with Kara and Kara II to reinforce contour and extend bandwidth to 32 Hz. SB18 features L-Vents that substantially reduce turbulence and port noise at high levels while also increasing LF efficiency.

The SB18 frequency response is optimized to couple perfectly with Kara and Kara II, in a flown and stacked configuration. SB18 is also an ideal subwoofer for X Series loudspeakers.

SB18 can be deployed in standard or cardioid configurations with dedicated presets.

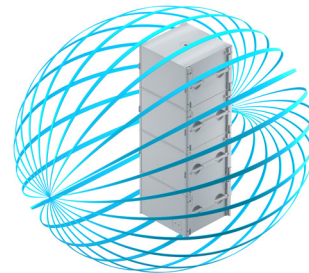

Rear SPL rejection (cardioid)

PHYSICAL

The SB18 enclosure is constructed of premium grade Baltic beech and birch plywood to ensure maximum acoustical and mechanical integrity. The protected cabinetry and robust design ensure longevity in storage and on-the-road manipulation.

SB18 integrates a four-point, captive rigging system that simplifies deployment and provides visual safety assessment. Four ergonomic handles facilitate handling. Ground runners and matching top tracks secure stacking deployment and corner stops protect the side panels.

SB18 has been weatherized to achieve an IP55 rating for outdoor operations.

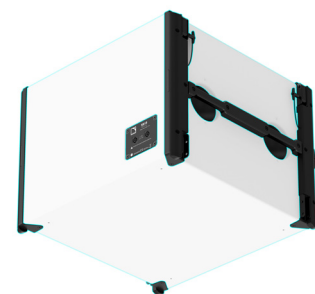

Integrated rigging with safety check; ergonomic handles and corner stops.

APPLICATIONS AND BENEFITS

SB18 is the ideal companion for small to large events that require full bandwidth extension in a compact enclosure. SB18 is acoustically compatible with Kara and Kara II and is also acoustically compatible with X Series loudspeakers.

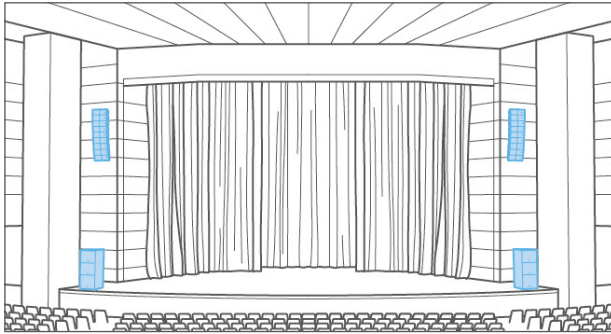

Fan-shaped amphitheater

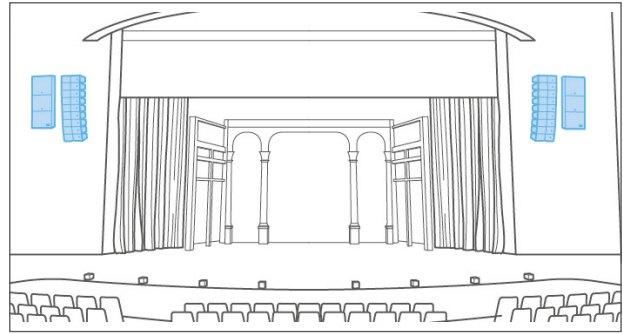

Shoe-box concert hall

RIGGING

SB18 can be ground-stacked vertically and horizontally. The M-BUMP flying frame supports flown vertical arrays in standard or cardioid arrangements. SB18 integrates a secure and easy-to-use rigging system that is compatible with Kara and Kara II to facilitate any combination of flown or stacked deployment.

Groundstacked Up to 4 SB18



M-BUMP Up to 16 SB18



KARA-MINIBU + MINIBUEX Up to 4 SB18



TRANSPORTATION ACCESSORIES

SB18-COV protective cover for 1 SB18

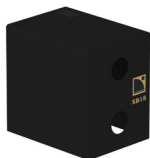

SB18-PLA removable front dolly for 1 SB18

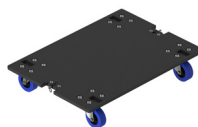

AMPLIFIED CONTROLLER

LA4X: amplified controller with DSP



4 x 1000 W / 8 ohms or 4 ohms
 4 inputs x 4 outputs architecture
 Max 4 enclosures per amplified controller

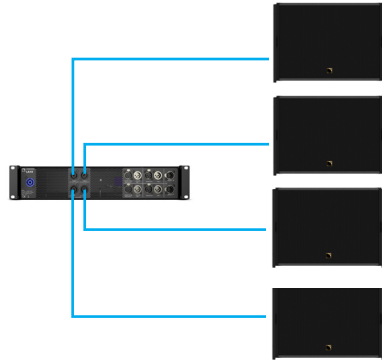

LA12X: amplified controller with DSP



4 x 3300 W / 2.7 ohms
 4 inputs x 4 outputs architecture
 Max 12 enclosures per amplified controller

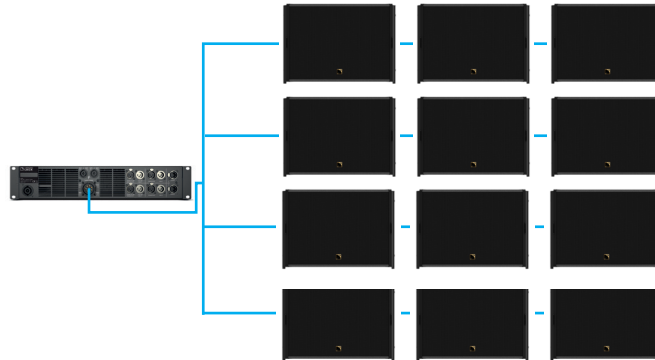

ASSOCIATED ENCLOSURES

Kara / Kara II



X SERIES



SOFTWARE

SOUNDVISION: simulation software

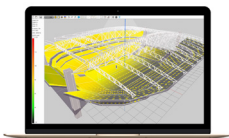

3D electro-acoustic & mechanical simulation software

LA Network Manager: control & monitoring software



Real-time control and monitoring up to 253 units
 Multiple network topologies



SB15m



SB18 (Ili)



KS21 (i)



K1-SB



SB28



KS28

Subwoofers: a complete range for professional sound reinforcement

L-Acoustics subwoofers complement systems in applications where extended bandwidth is required.

All subs incorporate high excursion drivers, ultra-low vibration walls and laminar airflow L-Vents with a flared profile, resulting in dramatic reduction of port noise, maximized dynamics, power handling and an exceptional level of performance.

SB 18 SUBWOOFER



Description	Compact subwoofer: 1 x 18" amplified by LA4X / LA8 / LA12X
Low frequency limit (-10 dB)	32 Hz ([SB18_100])
Maximum SPL¹	138 dB ([SB18_100])
Nominal directivity	Standard or cardioid configurations
Transducers	1 x 18" cone driver
Acoustical load	Bass-reflex, L-Vents
Nominal impedance	8 Ω
Connectors	IN: 1 x 4-point speakON LINK: 1 x 4-point speakON
Rigging and handling	Flush-fitting four-point rigging system 1 x 35 mm pole mount socket 4 handles, 8 protective corner stops
Weight (net)	52 kg / 115 lb
Cabinet	Premium grade Baltic beech and birch plywood
Front	Coated steel grill Acoustically neutral 3D fabric
Rigging components	High grade steel with anti-corrosion coating
Finish	Dark grey brown Pantone 426 C
IP	IP55



¹ Peak level at 1 m under half space conditions using pink noise with crest factor 4 (preset specified in brackets).

ISOCONTOUR

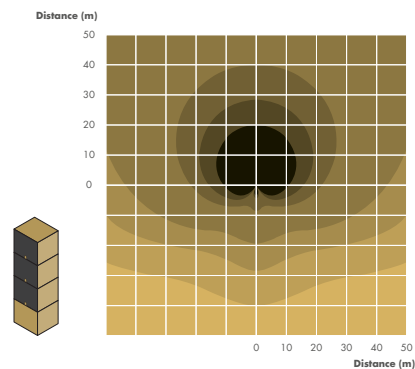
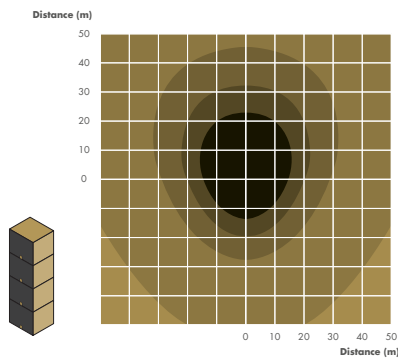

► SPL mapping of a block of four SB 18 in standard (left) and cardioid (right) arrangements, using surfaces of equal sound pressure with three dB step colored scale.

DIMENSIONS

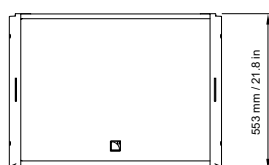

Front

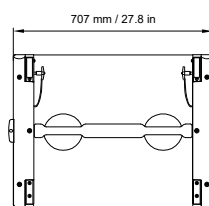

Side

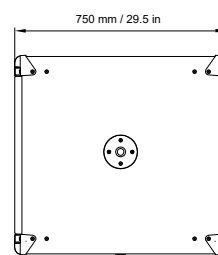

Top